

| Rev. | Description | Initiator | Date |
|------|--|-----------|-----------|
| 04 | ECO 15039; Updated to show TAP Ø10 Press Fit Dowel holes | SZJ | 2/14/2017 |

Customer machines mounting pattern as needed in plate. Remove plate prior to machining.

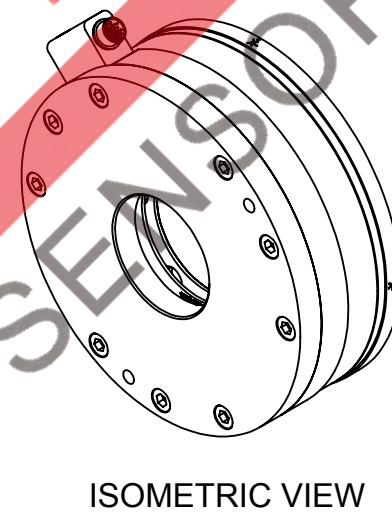
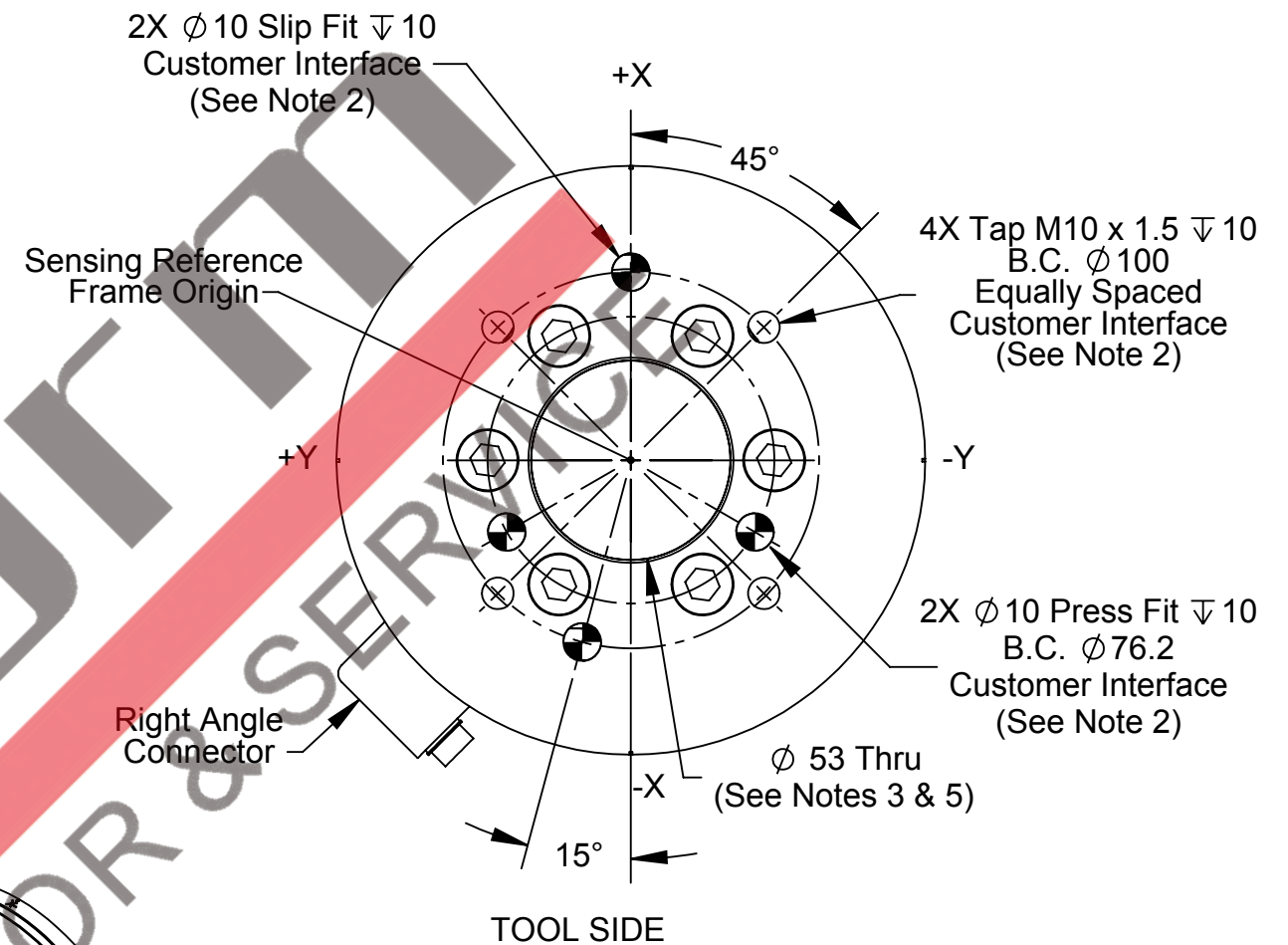
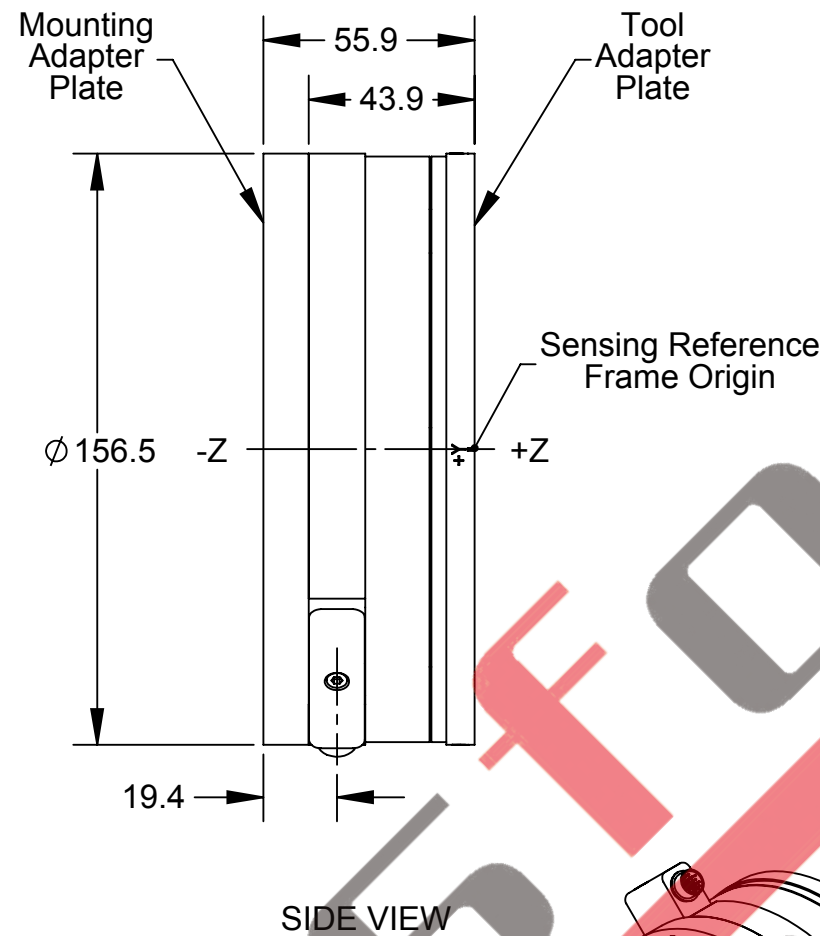
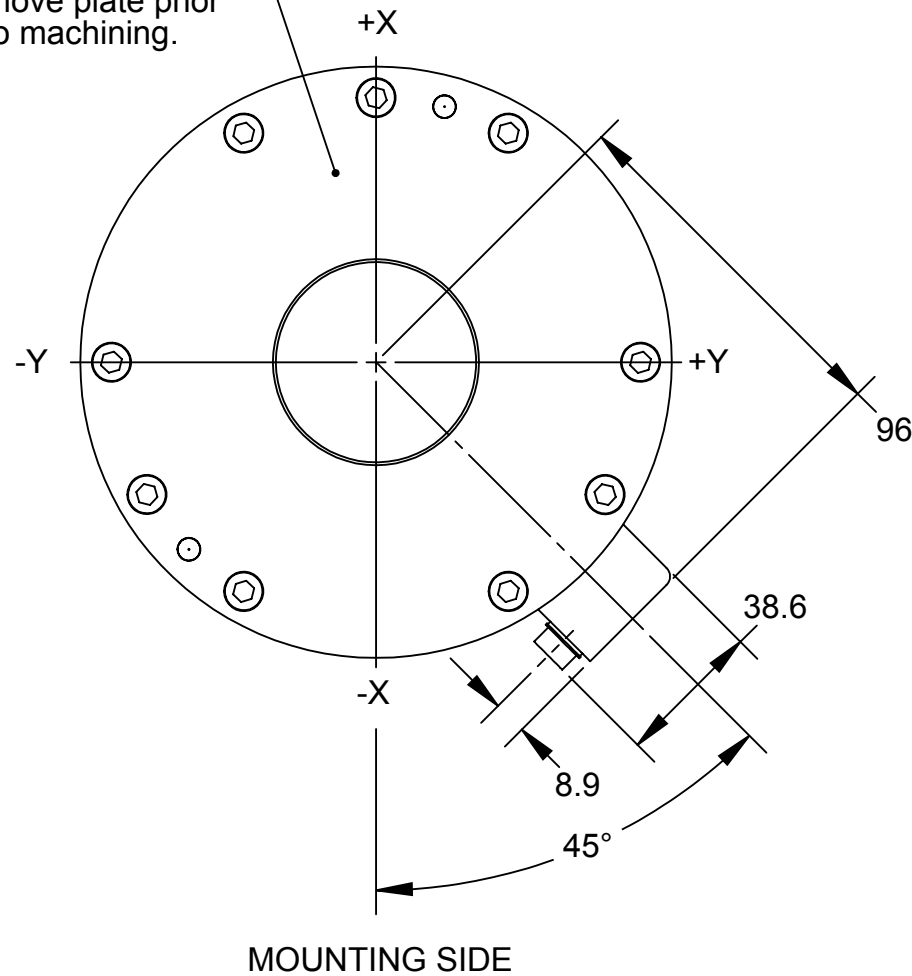

Notes:

1. Material: Hardened Stainless Steel and Aluminum.
2. **DO NOT EXCEED INTERFACE DEPTH, MAY CAUSE DAMAGE.**
3. Do not touch internal electronics or instrumentation. This could damage the transducer and will void warranty.
4. For best accuracy, transducer must be mounted to a surface rigid enough to support loads without deflection.
5. Do not allow items passing through center hole to contact transducer. Contact will affect reading accuracy.

NOTES: UNLESS OTHERWISE SPECIFIED.

DO NOT SCALE DRAWING. ALL DIMENSIONS ARE IN MILLIMETERS.

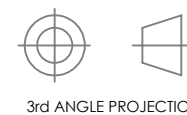

1031 Goodworth Drive, Apex, NC 27539, USA
 Tel: +1.919.772.0115 Email: info@ati-ia.com
 Fax: +1.919.772.8259 www.ati-ia.com
 ISO 9001 Registered Company

PROPERTY OF ATI INDUSTRIAL AUTOMATION, INC. NOT TO BE REPRODUCED IN ANY MANNER EXCEPT ON ORDER OR WITH PRIOR WRITTEN AUTHORIZATION OF ATI.

| | | | |
|-----------------------------------|--------------|---|-------------|
| DRAWN BY: L. Fisher, 12/13/11 | | TITLE | |
| CHECKED BY: R. Chambers, 12/14/11 | | TIF Omega160 Transducer with 53mm Thru Hole | |
| PROJECT # 111025-1 | SHEET 1 OF 1 | SCALE 1:2 | REVISION 04 |
| DRAWING NUMBER 9230-05-1412 | | SIZE B | |