

ROV SUBSEA PRESSURE TRANSDUCER

MODEL 7500-M254

FEATURES:

- Subsea depth rated to 30K ft WC (9,144 meters)
- Differential design for sea depth reference
- $\pm 0.2\%$ FSO accuracy
- Operating ranges to 10K PSI (689 BAR)

APPLICATIONS:

- ROV
- AUV
- Submarine
- Oil & gas subsea wellhead control systems

PRODUCT OVERVIEW:

The 7500-M254 from GP:50 is a subsea pressure transducer, designed for use within remote or unmanned vehicles. Its open reference provides for sea depth pressure. When used in a non-conductive fluid bladder, the transducer also provides a gauge process pressure. In addition to ROV applications, the compact size and sea rated construction of the 7500-M254 make it ideal for the effective monitoring of subsea oilfield wellhead control systems.



Model 7500-M254
ROV Subsea Pressure Transducer

GP:50 MODEL 7500-M254

DIMENSIONAL DRAWING

All dimensions are in inches (mm)

STANDARD WIRING

PIN	MODEL 7500-M254
A/1	+EXC/SIG
B/2	N/C
C/3	N/C
D/4	-EXC/SIG
E/5	N/C

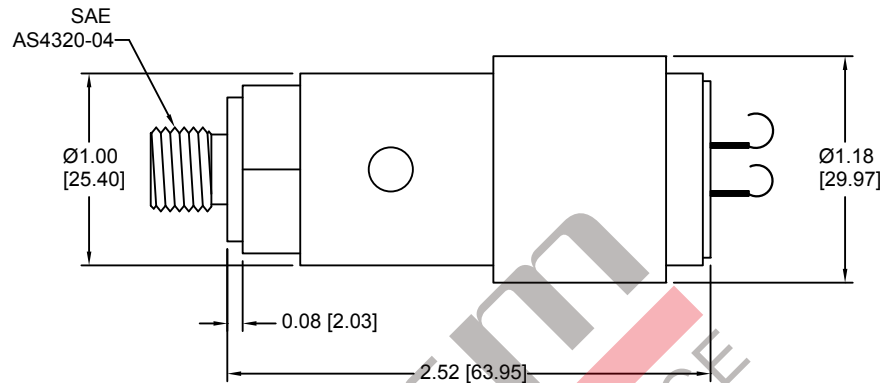

REFERENCE SPECIFICATIONS

ELECTRICAL <ul style="list-style-type: none"> • Excitation Voltage: 9 to 36 Vdc • Output Signal: 4-20 mA Optional mV/V or 0 to 5 Vdc • Connection: High-temperature solder J-hook connection 	MECHANICAL <ul style="list-style-type: none"> • Process connection: SAE AS4320-04 (M) (7/16-20 UNF) • Proof Pressure: 2X range • Burst Pressure: 3X range • Approximate Weight: 0.3 lb (127 gm)
MATERIALS OF CONSTRUCTION <ul style="list-style-type: none"> • Wetted Parts: Inconel 718 • Housing: 316L stainless steel 	PRESSURE RANGES <ul style="list-style-type: none"> • 500 PSI to 10K PSI (34 to 689 BAR)
STATIC ACCURACY (RSS) (HYSTERESIS, NON-LINEARITY & REPEATABILITY @ +70 °F) ±0.2% FSO	THERMAL SPECIFICATION <ul style="list-style-type: none"> • Zero balance and span: ±0.5% FSO • Compensated (ambient): +35 °F to +170 °F (+23 °C to +205 °C) • Operating (ambient): -20 °F to +190 °F (-4 °C to +205 °C) • Storage: -65 °F to +250 °F (-54 °C to +121 °C)*

*condensation free environment

**Standard configurations shown.
Please consult factory for other options.**

All specifications are for reference purposes only. In the interests of continuous product improvement, all specifications are subject to change without notice. Please contact GP:50 for assistance with your application.